

BLIND RIVET G-BRA REMACHE G-BRA





English	Español	Français	Deutsch	Portugues
Dome head	Cabeza alomada	Tête plate	Flachrundkopf	Cabeça boleada
Body: Steel * zincplated 8µ ***	Cuerpo: Acero * cincado 8µ ***	Corps: Acier * zingué 8µ ***	Hülse: Stahl * verzinkt 8µ ***	Corpo: Aço * zincado 8µ ***
Mandrel: Steel zincplated 8µ **	Vástago: Acero cincado 8µ**	Clou: Acier zingué 8µ **	Dorn: Stahl verzinkt 8µ **	Prego: Aço zincado 8µ **

* Steel /acero C15E2C ISO 4042/Zn8/An/T2

** Steel /acero ISO 4042/Zn8/An/T2

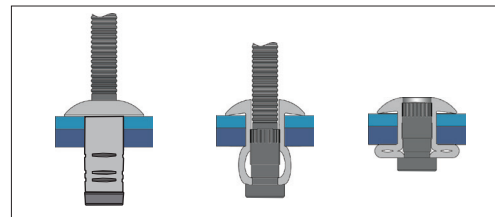
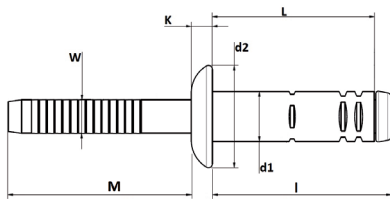
***Recubrimientos/Coatings according to ISO 4042

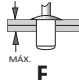

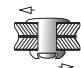
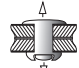
d1 Ø m/m	L Nominal m/m	 E m/m		d2 Ø m/m	K m/m	W m/m	I m/m	 (N)	 (N)	Part No./Ref.
6,4	12,7	2,0 - 4,5	6,70-7,00	12,5	2,70	4,30	15,5	8.500	8.000	G189A006413
	17,7	6,0 - 8,5	6,70-7,00	12,5	2,70	4,30	20,5	10.000	8.000	G189A006417
	20,7	8,5 - 11,0	6,70-7,00	12,5	2,70	4,30	23,5	11.000	8.000	G189A006420
	23,7	10,5 - 13,0	6,70-7,00	12,5	2,70	4,30	26,5	11.000	8.000	G189A006423
	25,7	12,5 - 15,0	6,70-7,00	12,5	2,70	4,30	28,5	11.000	8.000	G189A006425

Test according to / Ensayos realizados según EN ISO 14589

The total or partial reproduction of this document is prohibited. The figures showed in this catalogue are typical values and they could be changed as a result of the continuous improvement of products. Please, do not hesitate to contact us if you need an updated information. Queda prohibida la reproducción total o parcial de este documento. Los datos que aparecen en este catálogo son valores típicos y están sujetos a modificaciones como consecuencia de la mejora continua de los productos. Consúltenos si necesita información actualizada.